



ACSER. Escuadra reforzada galvanizada en caliente



> CARACTERÍSTICAS DE PRODUCTO

| | |
|----------|--|
| Material | Acero |
| Acabado | Galvanizado en caliente |
| Uso | Crear marcos de metal con perfiles Strut |

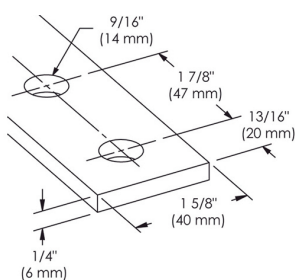
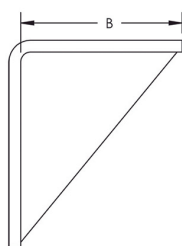
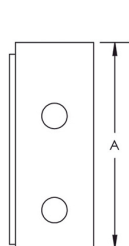

| Referencia | Para carril | Long. placa | Long. placa | Diámetro perforaciones | Separación entre perforaciones | Distancia al borde del eje de la perforación | Ancho de placa | Espesor de placa |
|------------|-------------|-------------|-------------|------------------------|--------------------------------|--|----------------|------------------|
| | | A | B | Ø | | | | |
| | | mm | mm | mm | mm | mm | mm | mm |
| ACSER102 | 41 x 41 | 102 | 89 | 14 | 47 | 20 | 40 | 6 |
| ACSER106 | 41 x 41 | 106 | 90,5 | 14 | 47 | 20 | 40 | 6 |